

# CORNER RESTORATION

**CORNER:** N1/4 SEC. 28, TWP. 9 S., RANGE 32 E., W.M.

**ORIGINAL SURVEY BY:** Herman D. Gradon, Deputy Surveyor

**CONTRACT NUMBER:** 416

**CONTRACT DATE:** August 19, 1881

**SUBSEQUENT SURVEYS:**

- ▶ By Howard Taylor in 1957
- ▶ By Robert Bagett, in 1972

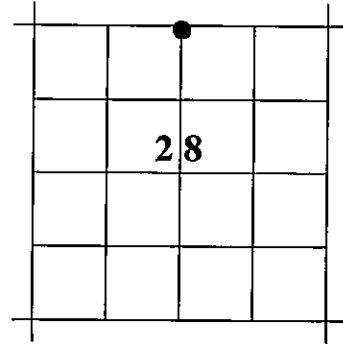

**ORIGINAL GLO DESCRIPTION:** Set a basalt stone 18x8x6 ins. 12 ins. in the ground for 1/4 sec cor. marked 1/4 on N. face and raised a mound of stone alongside.

- ▶ **Taylor's 1957 description:** Found Orig. stone. Scribed new BT's - 20" Pine S3E 173.8 ft. "1/4 S 28 BT"; 24" Pine S27W 224.8 ft. "1/4 S 28 BT"
- ▶ **Bagett's 1972 description:** Found basalt stone 18x8x6 marked 1/4 and firmly set in a mound of stone. Also found Taylor's bearing tree, which is now a 20" diam. stump mkd. BT. Mr. Taylor took two BT's for this cor. in 1957. Set 1 1/2 x 30 inch iron pipe 24 ins. in the ground. . . From which a 20" pine stump bears S.4°20'E, 174.9 ft. marked BT. **NEW BEARING TREES:** a 9" pine bears S.49°43'E., 183.3 ft. marked T9S R32E 1/4 S28 BT. A 14" pine bears S.6°10'W., 242.3 ft. marked T9S R32E 1/4 S28 BT.

**EVIDENCE FOUND:** Found Bagett's 1972 monument in good condition in a 3 foot mound of stone. There is a metal T post approximately 6 ft. North. The Southwest bearing tree is now a 27" diam. stump with indications of a healed blaze. We found the Southeast bearing tree (now 17" diam.) in good health with a fully healed blaze.

**DESCRIPTION OF MONUMENTS AND ACCESSORIES SET AND METHODS USED:** Set a fiberglass witness post 2 ft. South of brass cap. Cap is marked as shown below. We attached a new BT tag to the remaining 1972 bearing tree with record information on the new tag.

**FROM THE FOUND MONUMENT, I SET NEW REFERENCE POINTS:**

- A 5/8"x30" iron pin bears N.41°04'E., 16.91 feet with attached green plastic cap marked GCS RP;
  - A 5/8"x30" iron pin bears S.49°38'E., 34.88 feet with attached green plastic cap marked GCS RP;
  - A 5/8"x30" iron pin bears S.43°56'W., 13.52 feet with attached green plastic cap marked GCS RP;
  - A 5/8"x30" iron pin bears N.48°52'W., 21.42 feet with attached green plastic cap marked GCS RP;
- Used RTK GPS to measure the reference points. Bearings are based on Bagett's 1972 survey.

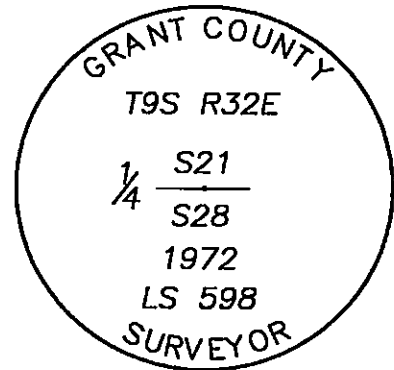

**STATE PLANE COORDINATES (3601 OR N)**

Reference Datum: NAD83(2011) from OPUS solution

Northing: 404,628.9 ft.  
 Easting: 8,625,438.1 ft.  
 Ellip. Ht: 3,302.7 ft.

**RESTORATION BY, STAMP AND DATE:**

**Michael C. Springer, PLS,**  
 Grant County Surveyor  
**Jason L. Hatfield, PLS,**  
 Deputy County Surveyor  
 P.O. Box 476  
 217 N. Canyon Blvd.  
 John Day, OR 97845

**RECEIVED AND FILED  
 GRANT COUNTY SURVEYOR**

MAY 29 2013

BY:



EXPIRES: 6/30/2014

Surveyed January 1, 2013  
 through May 16, 2013